

THESE DRAWINGS AND SPECIFICATIONS ARE THE PROPERTY OF JBL, INCORPORATED. THEY ARE ISSUED IN STRICT CONFIDENCE AND SHALL NOT BE REPRODUCED OR USED AS THE BASIS FOR MANUFACTURE OR APPARATUS WITHOUT WRITTEN PERMISSION.

| REVOLUTIONS | | DATE |
|-------------|-----------------------|-----------|
| 1.30 | DESCRIPTION | 3/21/2014 |
| A | RELEASE FOR MARKETING | JS |

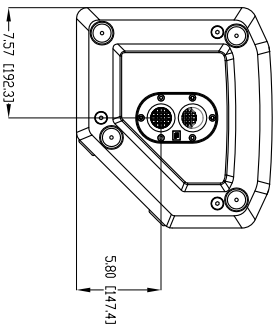
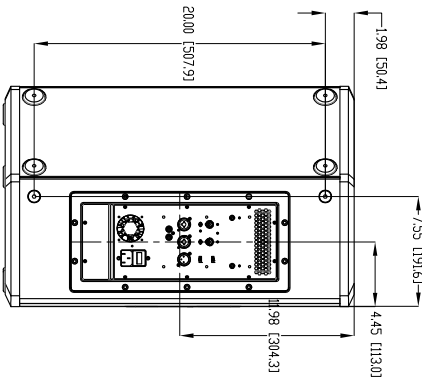
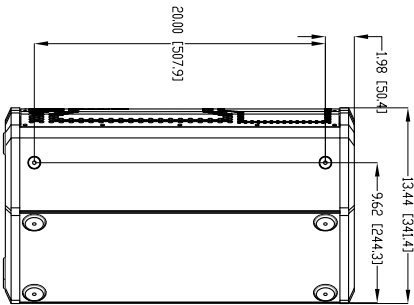
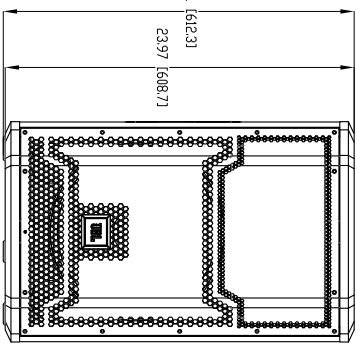
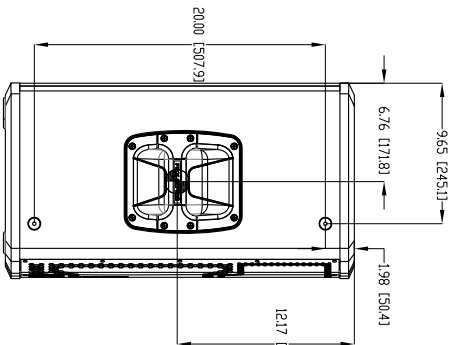
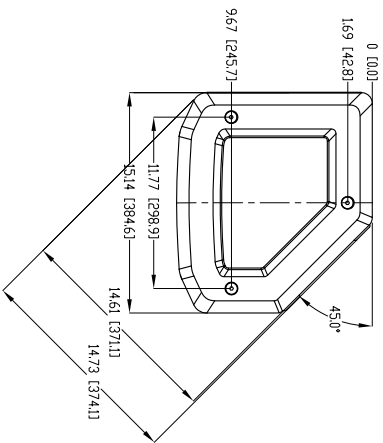

- NOTES:
1. COMPONENTS: LF 1X 2725-HF 1X 2408H-2
 2. INPUT 2X XLR WITH LOOP THRU
 3. GRILLE 1/4 GA. PREPERATED GRS POWDER
 4. COATED BLACK WITH CLOTH BACKING
 5. MATERIALS: 18mm BIRCH FACED PLYLAR
 6. FINISH: BLACK DURA-TEX
 7. SUSPENSION POINTS: 12X M10 THREADED SUSPENSION POINTS
 8. POLE MOUNT: DIA. 35mm (1-3/8") FEMALE SOCKET WITH 0 AND 15 DEGREE ANGING ANGLES.
 9. WEIGHT 44LBS (20 kg)
 10. Ⓢ INDICATES CENTER OF GRAVITY
- NOTES: (UNLESS OTHERWISE SPECIFIED)

| TOLERANCES (UNLESS OTHERWISE SPECIFIED) | |
|---|-----------------------|
| XXX ± .063 INCH | |
| XX ± .025 INCH | |
| ANGULAR TOLERANCE OF 0°±30° | |
| ALL DIMENSIONS ARE IN INCHES | |
| ALL DIMENSIONS ARE FINISHED DIMENSIONS | |
| DO NOT SCALE DRAWING | |
| JBL PROFESSIONAL A Harman International Company Northridge, California 91329 U.S.A. | |
| CUSTOMER DRAWING: PR3712 | |
| SIZE A | BRWING NO. 1000135404 |
| SCALE NTS | SHEET 1 OF 1 |